

Lubricated rotary vanes vacuum pumps, reliable and robust designed for low or medium vacuum.

	NOMINAL CAPACITY m <sup>3</sup> .h <sup>-1</sup>		PNEUROP CAPACITY m <sup>3</sup> .h <sup>-1</sup>		END VACUUM mbar		MOTOR POWER kW		ROTATION SPEED rpm		NOISE LEVEL dB(A)	OIL FILLING L	WEIGHT kg
	50 Hz	60 Hz	50 Hz	60 Hz	WITHOUT GAS BALLAST	WITH GAS BALLAST	50 Hz	60 Hz	50 Hz	60 Hz			
	<b>E17</b>	17	20	16	19	0,5	1,5	0,55	0,66	1000			
<b>E25</b>	30	36	28	33	0,5	1,5	0,75	0,90	1450	1740	60	1,5	35
<b>E40</b>	47	56	41	49	0,5	1,5	1,10	1,30	1450	1740	62	1,5	45
<b>E65</b>	65	78	63	75	0,5	1,5	1,50	1,80	1450	1740	65	4	70
<b>E100</b>	96	115	94	112	0,5	1,5	2,20	2,64	1450	1740	67	4	80
<b>E150</b>	150	180	147	176	0,1	1,2	3,00	3,60	1450	1740	70	7	102
<b>E200</b>	190	228	185	222	0,1	1,2	4,00	4,80	1450	1740	71	7	115
<b>E300</b>	288	345	263	315	0,1	1,2	5,50	6,60	1450	1740	73	7	190
<b>E350</b>	360	432	341	409	0,1	1,2	7,50	9,00	967	1160	74	10	350
<b>E400</b>	426	511	410	492	0,1	1,2	9,00	10,80	967	1160	74	10	380
<b>E500</b>	513	616	496	595	0,1	1,2	11,00	13,20	967	1160	74	10	420
<b>E600</b>	632	758	597	716	0,1	1,2	15,00	18,00	967	1160	75	10	450

## Average evacuation time (50 Hz)

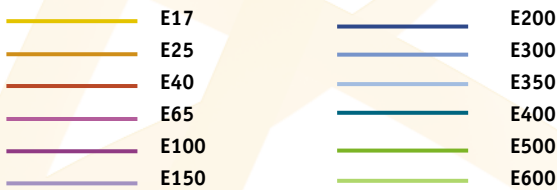
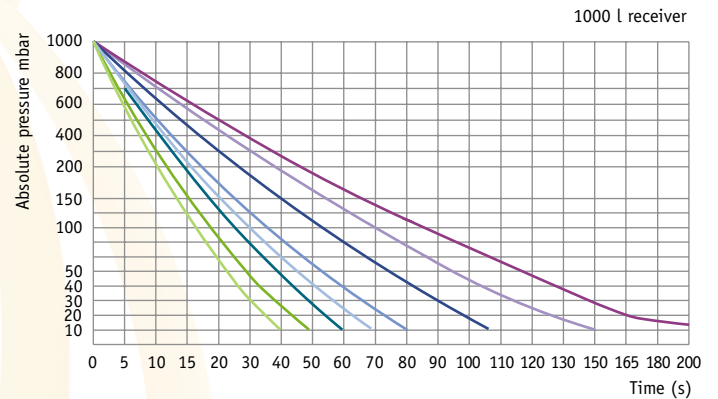
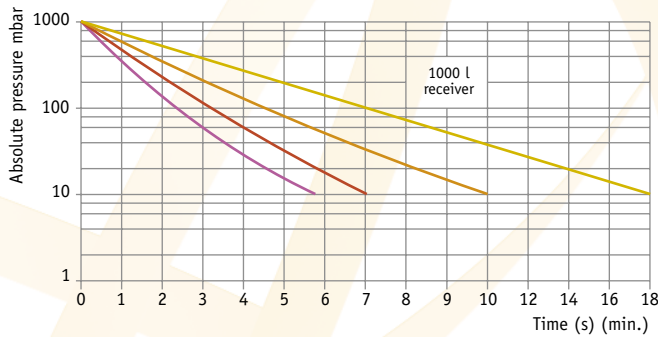

## Capacity - pressure curve without gas ballast (50 Hz)

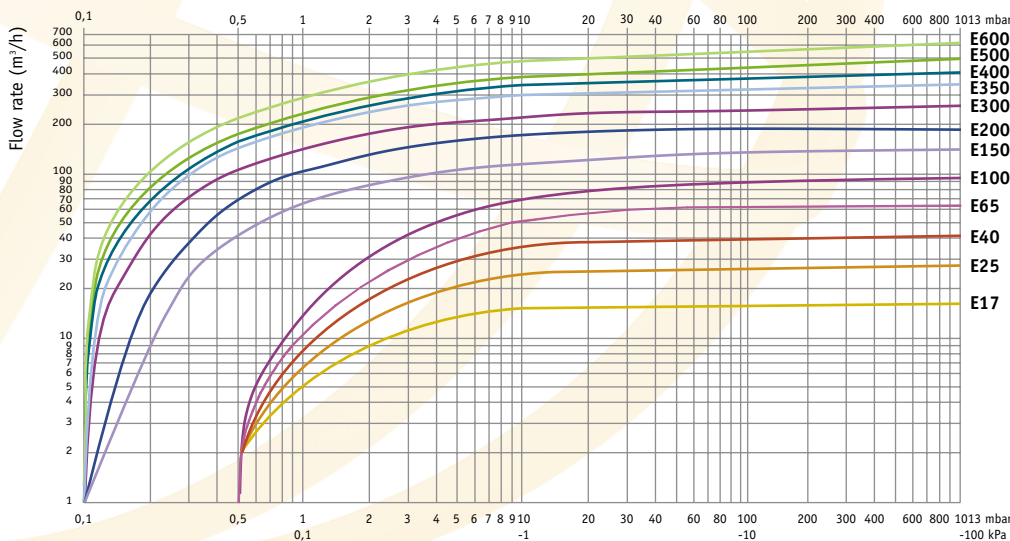

# Lubricated rotary vanes vacuum pumps

- Built for heavy applications
- Suitable for high water vapour tolerance
- Continuous running from atmospheric pressure to end vacuum
- Air cooling (several modes further to applications)
- Standard motor coupling
- PF55 motor - F class
- Available in oxygen version with specific oil
- ATEX version : on request

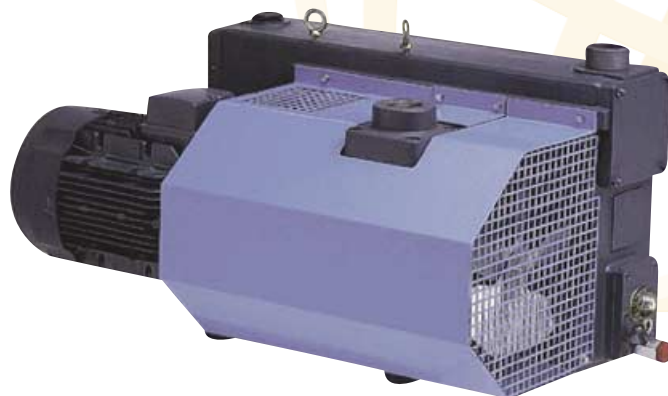

## Standard power supplies

	50 Hz V±10%	60 Hz V±10%
1-ph	230	265
3-ph	230/400	265/460

Special supplies on request

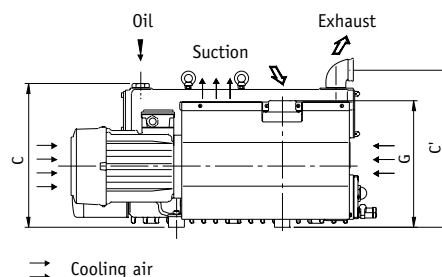
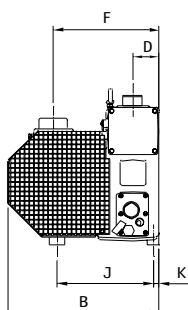

E17 - E25

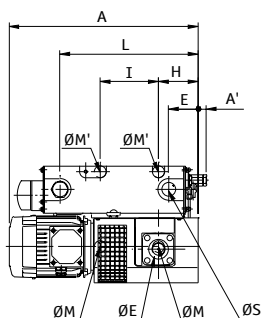

E40 - E65 - E100 - E150

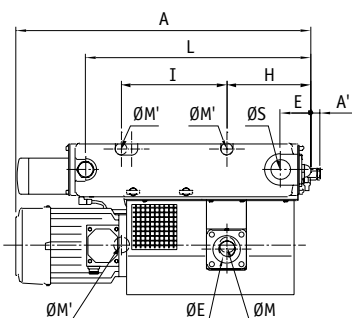

E200 - E300 - E350 - E400 - E500 - E600

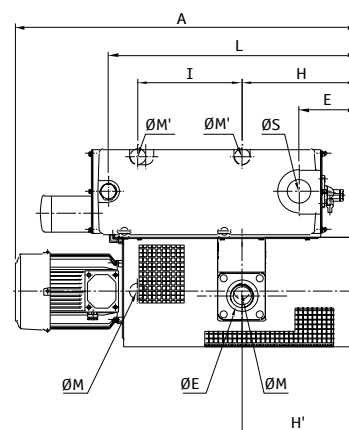

## Dimensions

	A	B	C	A'	C'	D	E	F	G	H	H'	I	J	K	L	ØM	ØM'	ØE	ØS
E17	466	296	276	36	290	60	61	212	253	87	-	148	190	15	337	M8	M8	1"	1"
E25	466	296	276	36	290	60	61	212	253	87	-	148	190	15	337	M8	M8	1"	1"
E40	571	296	276	-	290	60	126	212	253	152	152	185	190	15	402	M8	M8	1"	1"
E65	683	385	365	25	379	67	80	270	322	214	-	243	245	15	574	M10	M8	1 1/4"	1 1/2"
E100	751	385	365	25	379	67	80	270	322	214	-	269	245	15	574	M10	M8	1 1/4"	1 1/2"
E150	792	504	401	25	415	108	88	375	364	234	-	246	343	20	574	M10	M10	2"	2"
E200	873	504	401	-	415	108	149	375	364	295	295	266	343	20	635	M10	M10	2"	2"
E300	1055	584	421	-	436	145	259	450	386	363	363	318	412	25	820	M10	M10	2"	2"
E350	1358	680	544	-	614	145	260	510	510	408	458	376	462	30	814	M10	M10	DN80	G3"
E400	1425	680	544	-	614	145	331	510	510	477	477	376	462	30	884	M10	M10	DN80	G3"
E500	1473	680	544	-	614	145	364	510	510	512	512	376	462	30	918	M10	M10	DN80	G3"
E600	1621	680	544	-	611	145	411	512	510	558	558	376	464	30	965	M10	M10	DN80	G3"



**1**  
Suction filter with paper, polyester or activated carbon cartridges



**2**  
Vacuumtight suction filters



**3**  
Vacuum meter adaptable on filter cap



**4**  
Adjusting valve fitted on T-square

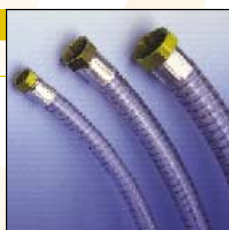

**5**  
Suction hoses

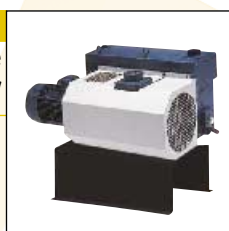

**6**  
Base frame assembly



**7**  
Polyester/carbon double filtration



**8**  
Reversed paper double filtration

## Pumps references

With MV46S oil filling	1-ph	230V
	3-ph	230/400V
	3-ph Adf	Eexd II CT4
	Special OXYGENE	230/400V
Cooling system for vapors suction	3-ph	230/400V
	1-ph	230V
Classic cooling system	3-ph	400V
Regulated cooling system	3-ph	400V

## Accessories and options references

<b>1</b> Fitted suction filter	PA : paper
<b>2</b>	PO : polyester
	CH : carbon
<b>3</b> Fitted vacuum meter	
Fitted gas ballast	
Additional filter for gas ballast	
<b>4</b> Adjusting valve fitted on T-Square (without filter)	
Oil level safety (OLS)	
Timer OLS in box to be fixed to the base frame	
<b>5</b> Suction hoses with check valve (except E350 to E600)	see page 17
<b>6</b> Base frame assembly	
Elevated base frame with retention vat	for 1 pump
Base plate for LG7 box	
Heating system (heater and temperature indicator)	
Monitoring of temperature	Mechanical thermostat
	Digital display panel + PT100
Heating control board and FLEXO solenoid valve - 400V+N	Pre-heating + rinsing
	Rinsing
Direct starter	without control panel
	3-ph 400V
	3-ph 230V
	1-ph 230V
	with LG7 start and stop system
	3-ph 400V
	3-ph 230V
	1-ph 230V
Star/delta starter 400V+N+E	
	with : 1 electric atmospheric pressure valve (230V-50 Hz)
	or 1 pneumatic atmospheric pressure valve (6 bar)
<b>7</b> Double suction filter	Polyester / carbon
<b>8</b> Double suction filter	Reversed paper filtration
<b>9</b> Cyclonic inlet vacuum precleaner filter	see page 14
<b>10</b> Dust separator with removable bag	see page 14
<b>11</b> Cyclonic liquid trap	see page 15



## Accessories and options references (to be continued)



Cyclonic inlet vacuum precleaner filter



Dust separator with removable bag



Cyclonic liquid trap



Liquids trap protecting vacuum pumps against liquids



Butterfly valve



Vertical vacuum receiver

<b>Additional oil exhaust filter</b>	
<b>Butterfly cast iron valve DN80 with electric actuator</b>	
230V - 50 Hz - opening time : 20 seconds with integrated delaying	
<b>13</b>	<b>Double acting pneumatic butterfly cast iron valve DN 80 with electric actuator 5/2 NF - 230V - 50 Hz</b>
<b>Frequency converter</b>	3-ph 400V - 50 Hz
<b>PNEUROP inlet flange</b>	
<b>12</b>	<b>Vacuum liquids traps</b> <a href="#">see page 16</a>
<b>14</b>	<b>Vertical vacuum receiver</b> <a href="#">see page 20</a>
<b>15</b>	<b>Electrovalves and valves</b> <a href="#">see page 18</a>
<b>Special oil for vacuum pump</b> <a href="#">see page 23</a>	
<b>16</b>	<b>Air cooler</b> <a href="#">see page 17</a>

The carbon filter has to be combined with paper or polyester downstream to avoid carbon migration in

## Standard configuration example

- EVISA vacuum pump
- MV 46 S oil
- PO suction filter
- Gas ballast (in case of wet environment)
- Base frame (from EVISA E65 model)
- Star-delta starter and offload starting valve (from EVISA E 400 model)

E17	E25	E40	E65	E100	E150	E200	E300	E350	E400	E500	E600
	618259		618260		618261						
									617522		
									617523		
	361617	361618	361619	361620	361621	361622	361623	361624	361625		
	117133 (25KF)		117134 (40KF)		117132 (50 KF)			117130 (80 ISO K)			

the pump

15

Electrovalves  
and valves



16

Air cooler

